

Furniture  
That Fuels  
The Future

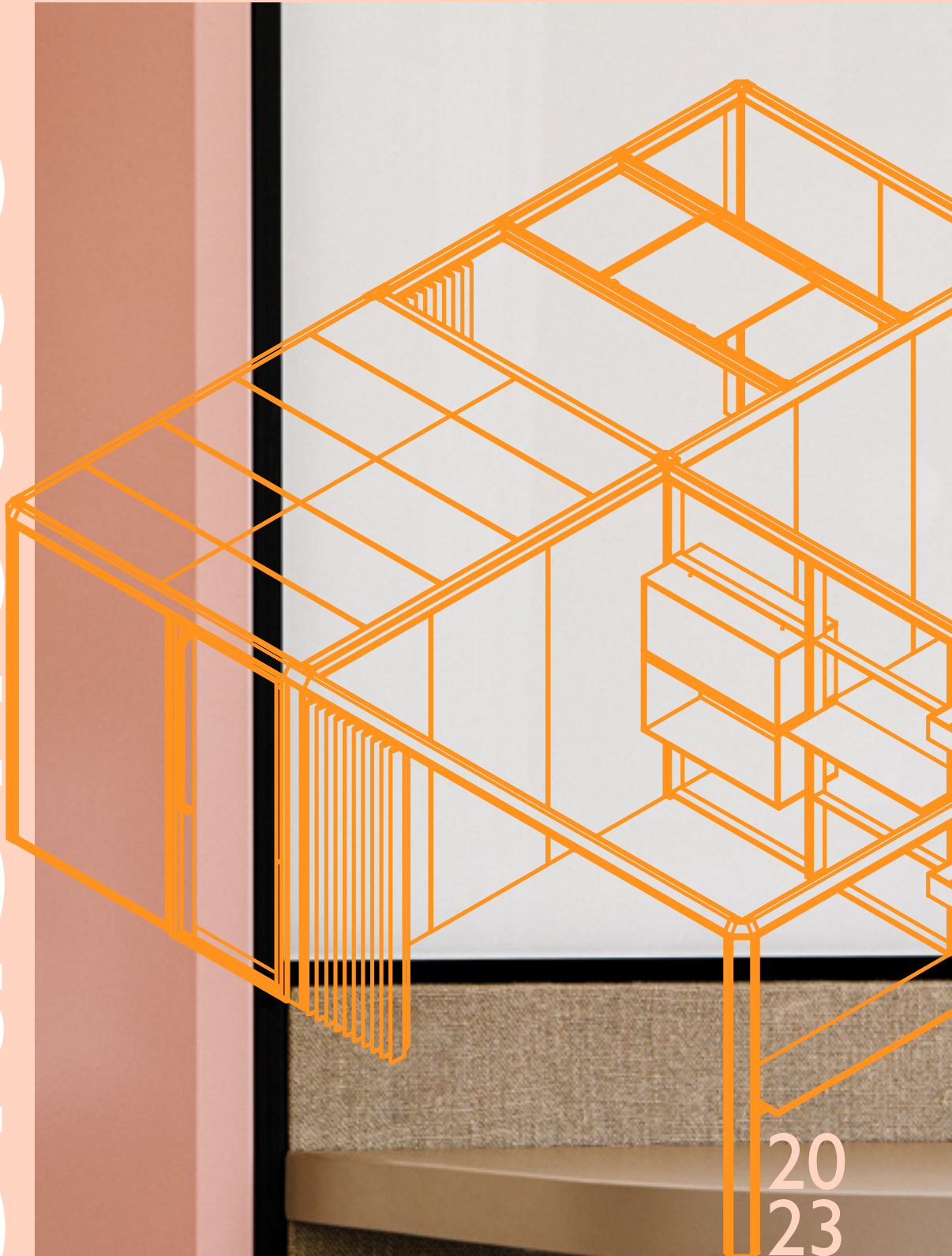

# Clubhouse



20  
23

Brochure

# CONTENTS

Clubhouse	1
Co-Create	3
Booth Option Guide	5
Personal Pod	7
Solo Sanctuary	9
Hush Hideout	11
Brainstorm Bay	13
Quad Quarters	15
Collaborative Coves	17
Meeting Modules	19
Hive Hub	21
Finishes	23



The mark of  
responsible forestry



Welcome to the world of Clubhouse, a revolutionary system of acoustic frames and panels designed to create customised, flexible structures that meet all your privacy needs. Whether you require a small phone booth for private conversations or a larger, more complex structure with varying levels of technology integration, Clubhouse has got you covered.

At the heart of Clubhouse's design is its highly rated acoustic performance, which ensures that conversations remain confidential and free from outside distractions. The modular panels and frames are customisable and can be easily assembled and reconfigured to fit any space or purpose. Shorter leases and the desire not to fix into the buildings fabric, avoiding costly dilapidations creates the need for these flexible and portable room systems.

Clubhouse's sleek design and variety of materials offer a stylish solution to your soundproofing needs, without compromising on functionality. With advanced features like ventilation, lighting, and technology integration, Clubhouse offers a complete solution for all your workspace needs.

So, whether you're looking to create an intimate phone booth or a large, more complex structure for meetings and brainstorming sessions, Clubhouse is the perfect solution. Explore our range of options and discover how Clubhouse can transform your workspace into a private and productive environment.

[illegible]

# Future Workspaces

Exploded  
components

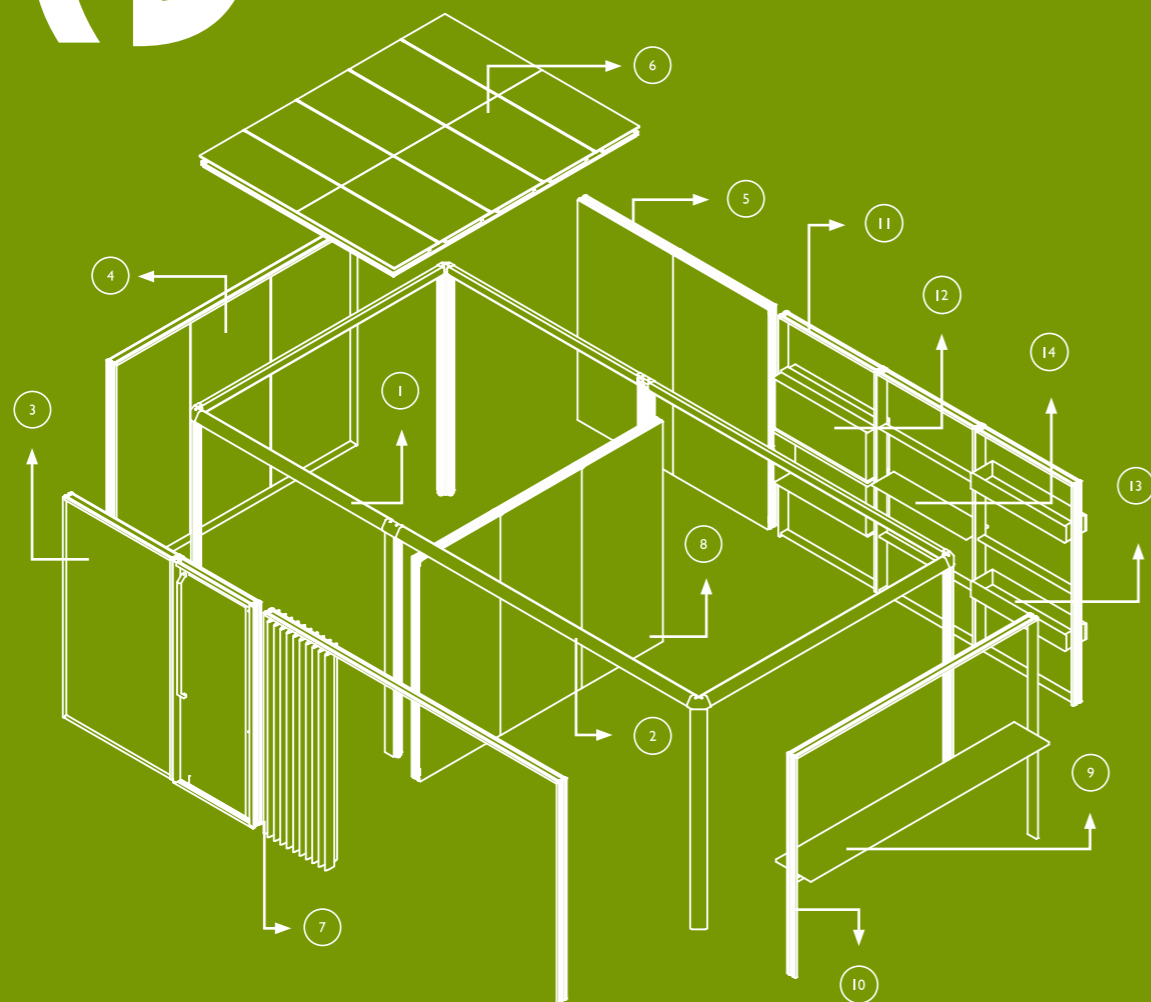

1

CLH/FW/S/24-30  
Single Room Framework 2.4m x 3.0m

2

CLH/FW/E/30-36  
Extension Room Framework 3.0m x 3.6m

3

CLH/WA/G+D/24  
Glazed Wall with Door - 2.4m

4

CLH/WA/G/30  
Glazed Wall- 3.0m

5

CLH/WA/S/FAB/24  
Fabric Wall

6

CLH/CE/LED/24/30  
Echophon ceiling tiles with LED light panels 2.4m x 3.0m

7

CLH/WA/C/36  
Curtain

8

CLH/WA/S/B+F/30  
Wall - Back Painted Glass or Fabric

9

CLH/A/T/30  
Bar Top

10

CLH/WA/B/30  
Bar Top Wall

11

CLH/WA/SL/36  
Shelf Wall

12

CLH/MFCBOX/1078/518/250  
MFC Box

13

CLH/MFCPLANT/1078  
MFC Planter box

14

CLH/MSH/1078  
MFC Shelf

Clubhouse offers a range of unique features that set it apart from other office pod systems. One key feature is its chamfered posts and edges throughout the frame, which give it a sleek and modern look. The acoustic qualities are also accentuated with 10mm glass panels, providing a quiet and private environment for meetings and phone calls. Clean lines and few visible fixtures contribute to its modern and streamlined design. With unlimited configurations, Clubhouse is highly customisable, from small single booths to multiple rooms. Its solid structure and sturdiness provide a reliable and secure workspace.

Clubhouse offers a range of optional add-ons to customise your workspace to meet your specific needs, including a retractable roof, which is not only a great design feature but also fire safety compliant. An open-ended room is available and multiple finish selections provide the option to add colour and texture to the workplace. Finally, Clubhouse provides a great sound-insulated phone booth without requiring an added structured floor and is DDA compliant, ensuring it is accessible to all.

# Booth Option Guide



Personal Pod

The ultimate video call workspace. With advanced technology, superior sound insulation, and echo-free acoustics, stay focused and connected from anywhere.

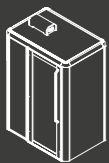

Solo Sanctuary

The perfect place for private calls and video conferences. With outstanding soundproofing and echo-free acoustics, have discussions in privacy without disturbing colleagues. Automatic ventilation creates a comfortable environment for one.

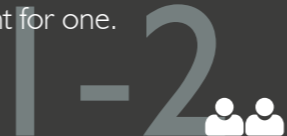

Hush Hideout

A multifunctional, soundproof pod for 2 people. Perfect for private meetings and brainstorming sessions without disturbing the office. Fits seamlessly into any office space.

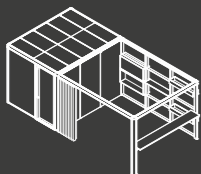

Brainstorm Bay

Designed for co-creation and brainstorming. The meeting room fits 4 people complete with superior sound insulation and echo-free acoustics to ensure meetings don't disturb the office. Accompanied with an open-end room to create a relaxed breakout area accessorised with open shelving and curtain depending on your privacy needs.

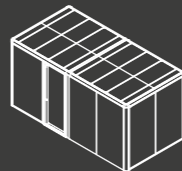
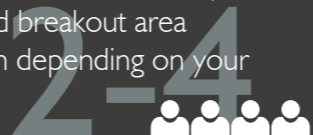

Quad Quarters

Two adjoining small meeting spaces for 4 people each – ideal for mini team collaborations. Privacy is created with solid walls or 10mm glazed panels to provide excellent soundproofing and ensure discussions won't disturb the surrounding office environment.



Collaborative Coves

Medium meeting space for 4-6 people, perfect for small team collaborations or intimate meetings. With leading sound insulation and echo-free acoustics ensuring privacy and focus, making it easy to hold productive meetings whether brainstorming ideas or discussing important topics to get the job done.

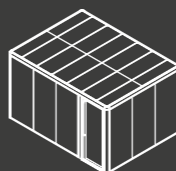

Meeting Modules

Large conference style meeting space for 8-10 people, making it the perfect choice for important discussions or formal presentations. With ample space, this room is designed to provide a comfortable and professional environment, complete with leading sound installation and echo-free acoustics to ensure that your meeting runs smoothly. The sleek design and modern aesthetic make a bold statement in any office, while the solid walls or glazed panels ensure privacy without isolating you from the rest of the office environment.

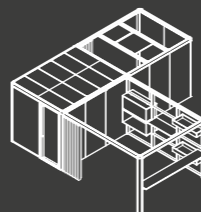

Hive Hub

This intricate L-shaped system displays modular workspace system. Containing a small meeting room featuring glass panels for added privacy, you can conduct important discussions or brainstorming sessions with ease. The two open-ended systems on either end offer unique design elements - one with multiple shelving systems for storage and organisation, and the other with an overhead gantry and curtain for a sense of enclosure. This comprehensive configuration is designed to be highly adaptable and flexible, accommodating various working styles and needs.





# Personal Pod

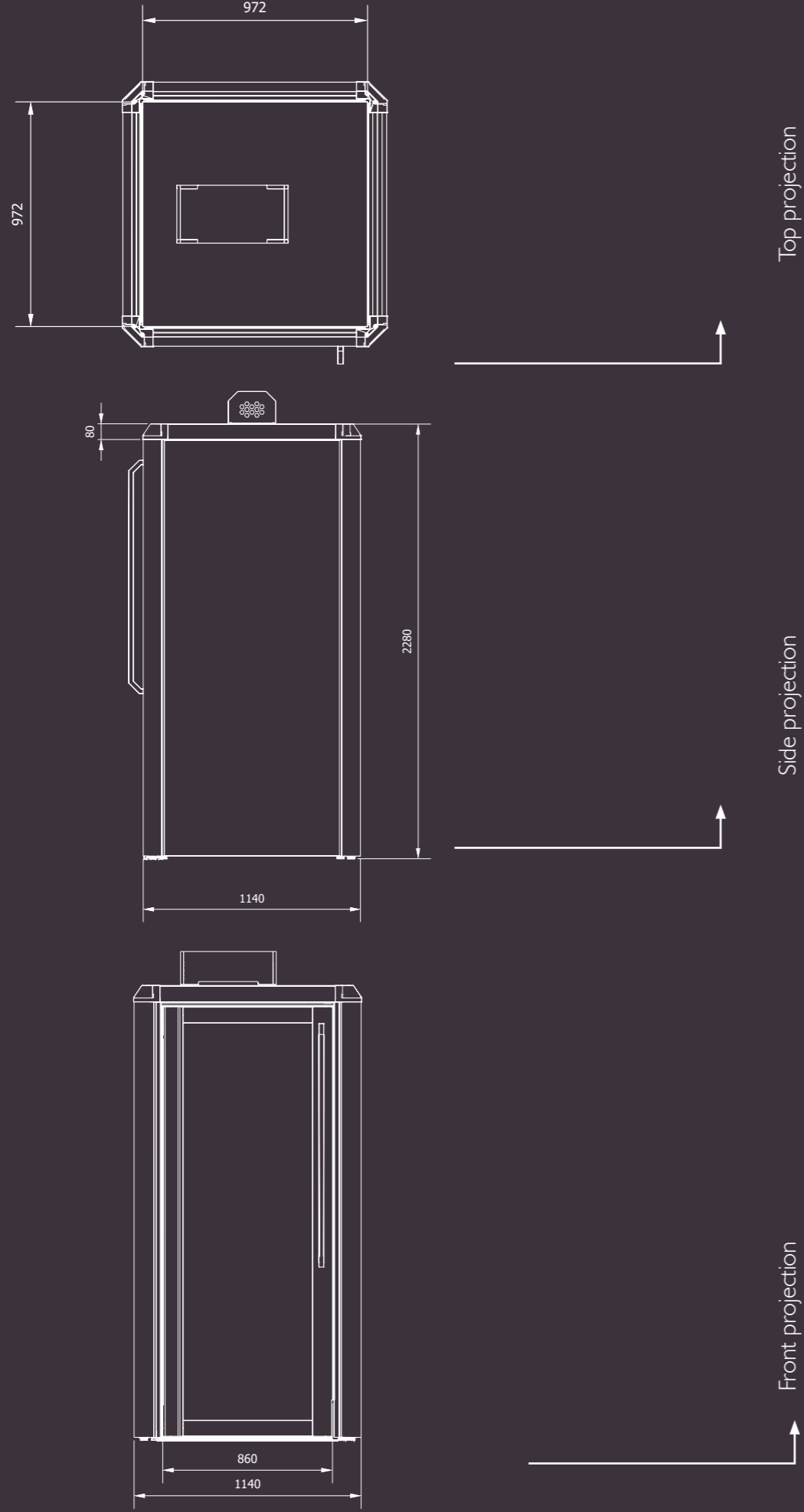

All measurements  
are in millimetres

I-2 

# Solo Sanctuary

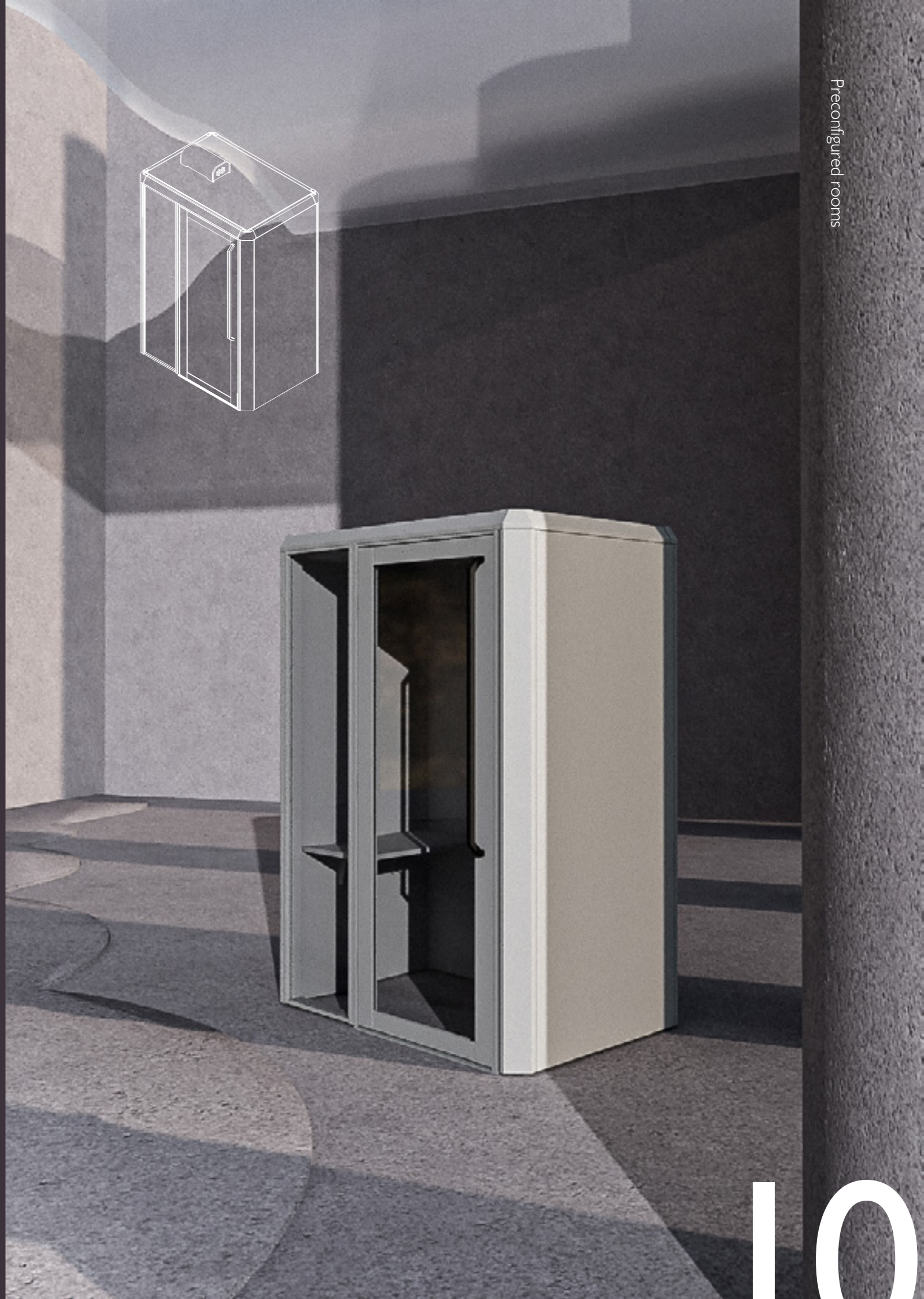
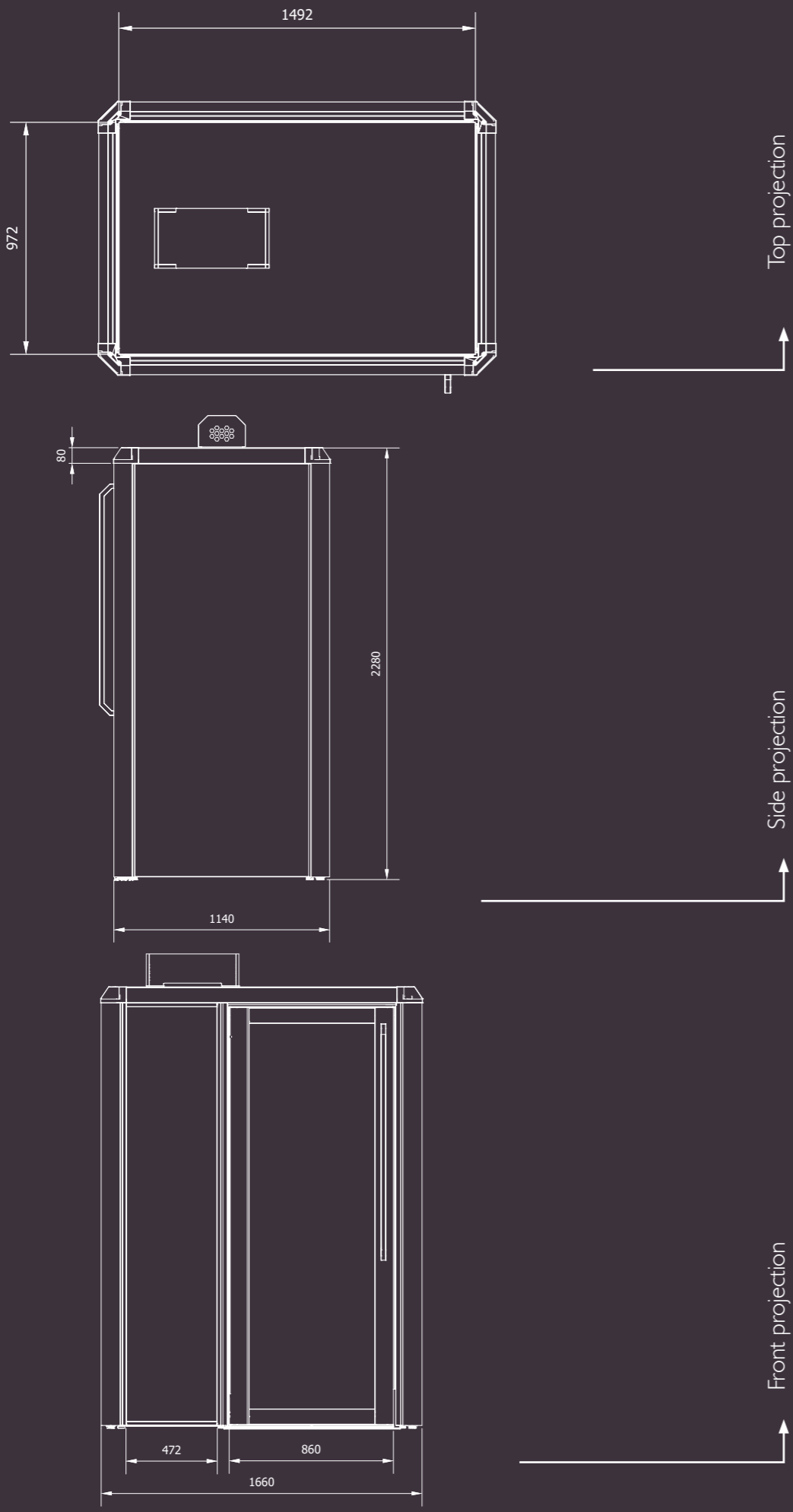

All measurements  
are in millimetres

I-2

# Hush Hideout

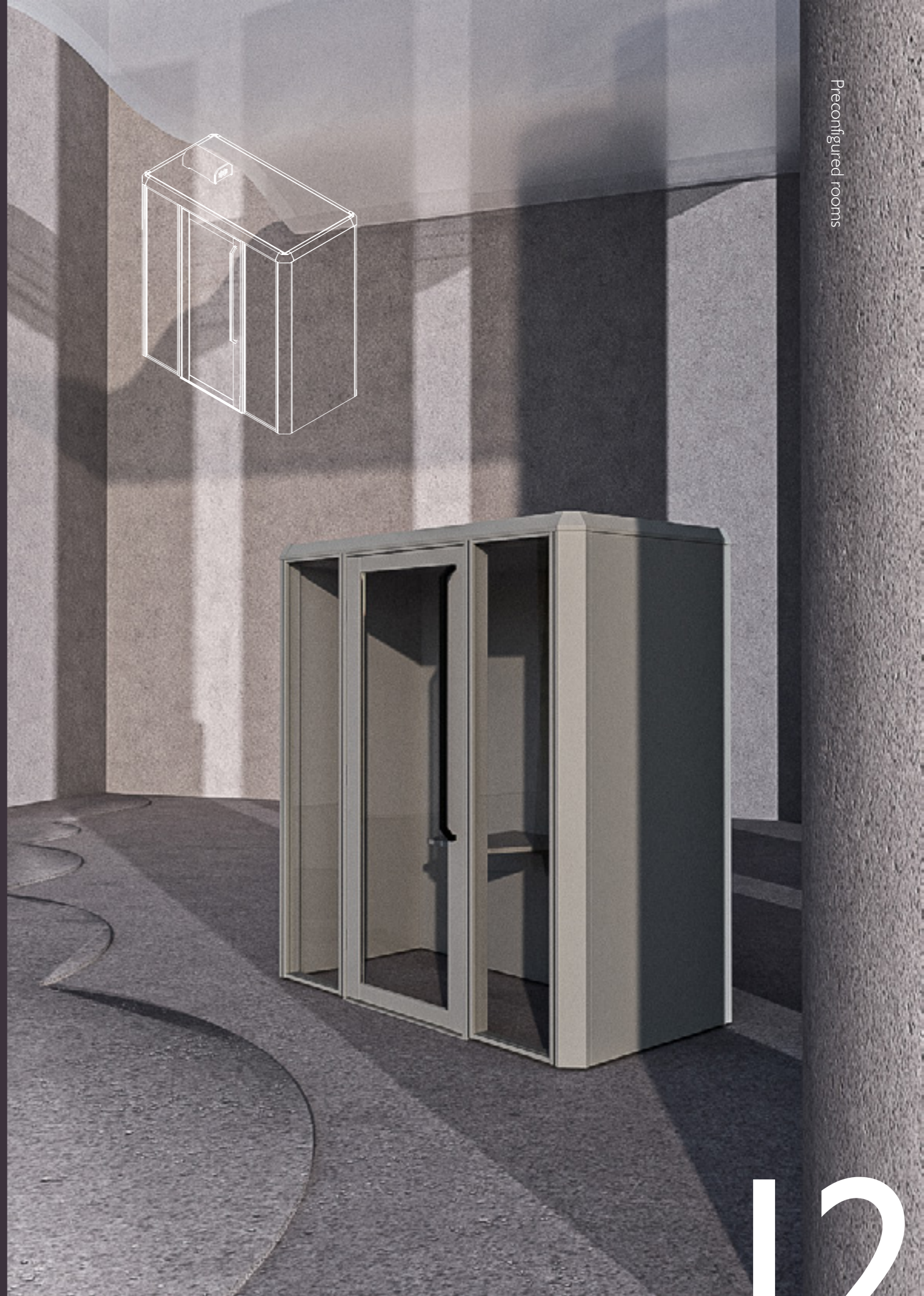
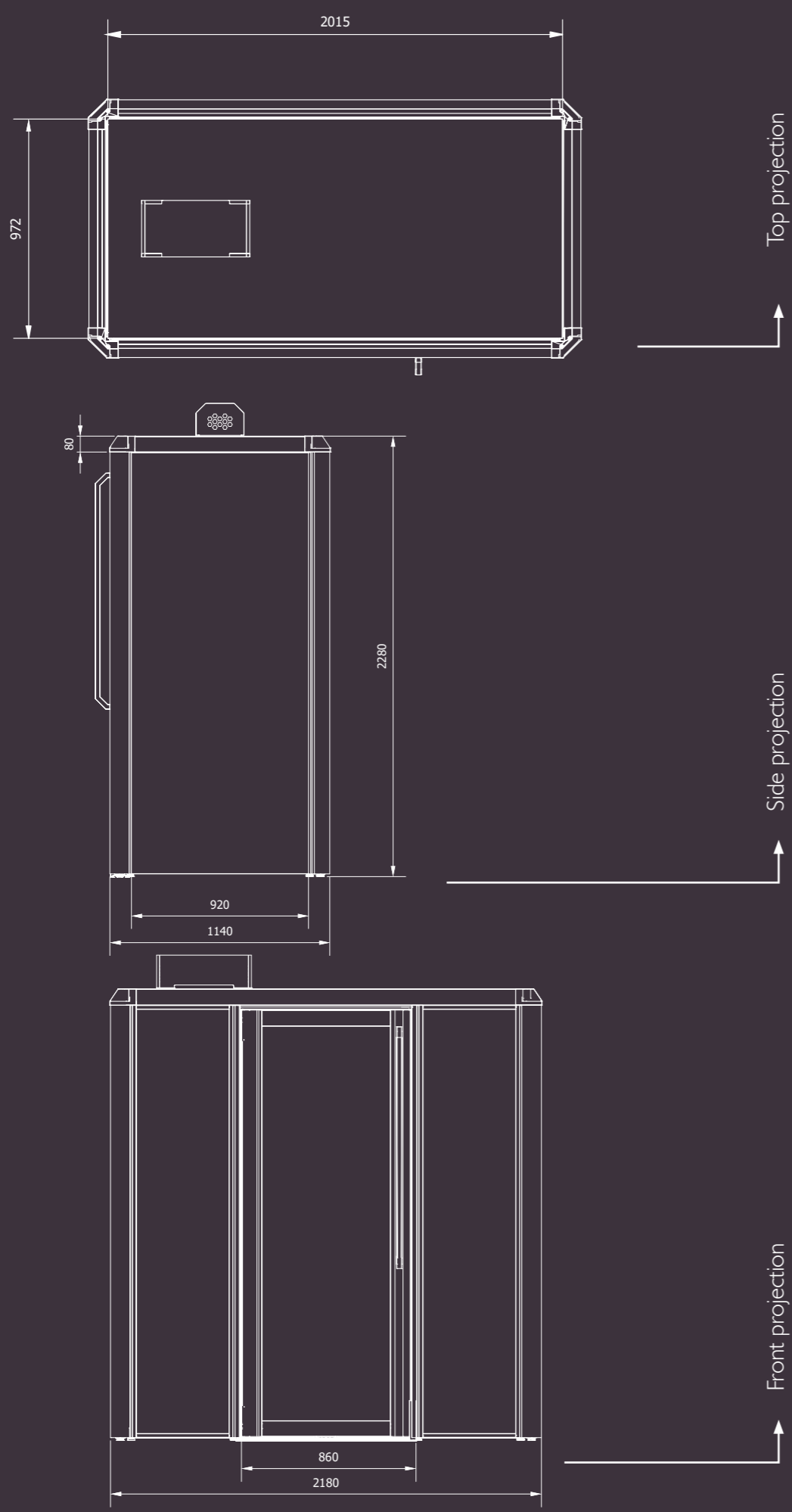

Preconfigured rooms

I-2

All measurements  
are in millimetres



# Brainstorm Bay

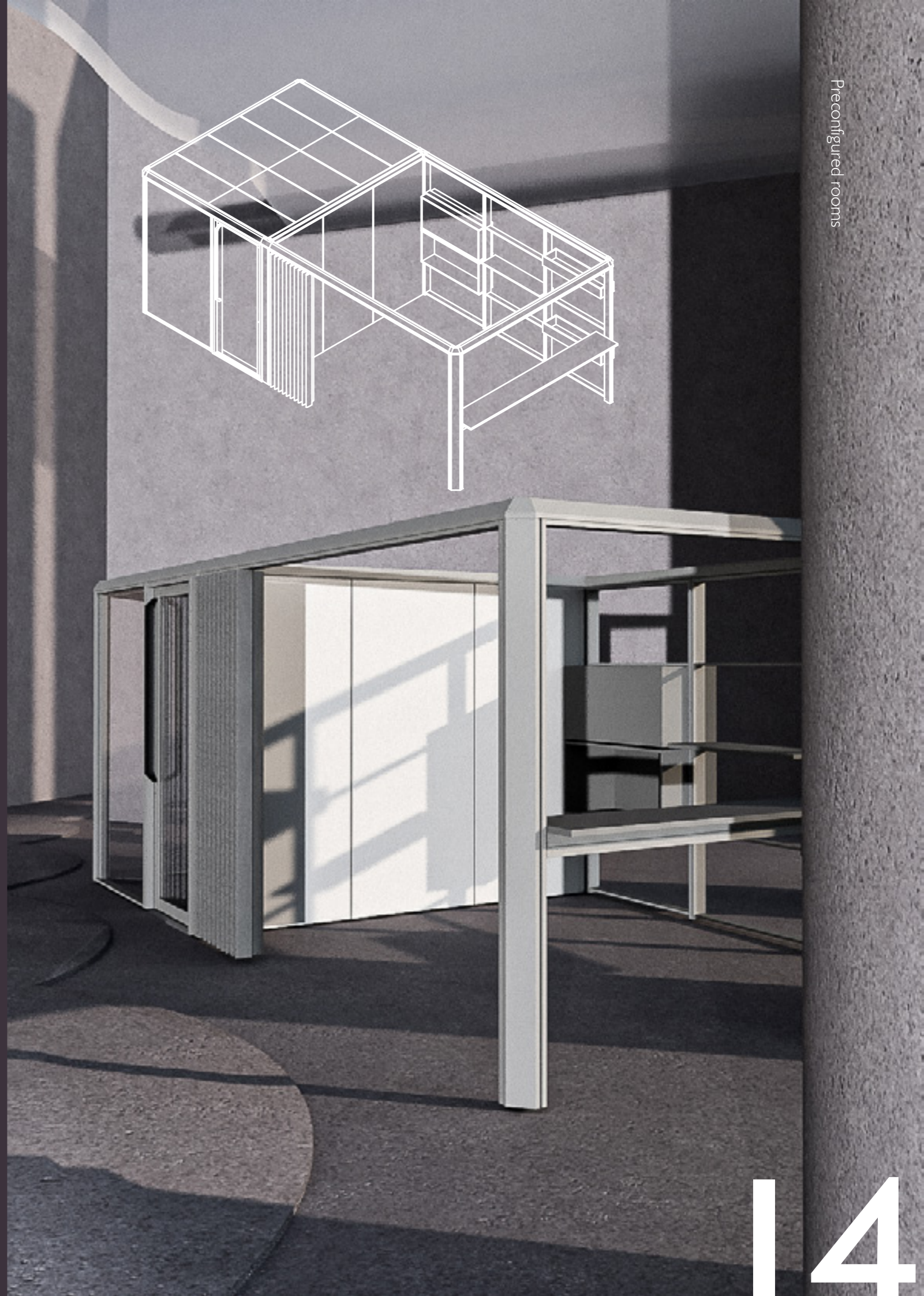
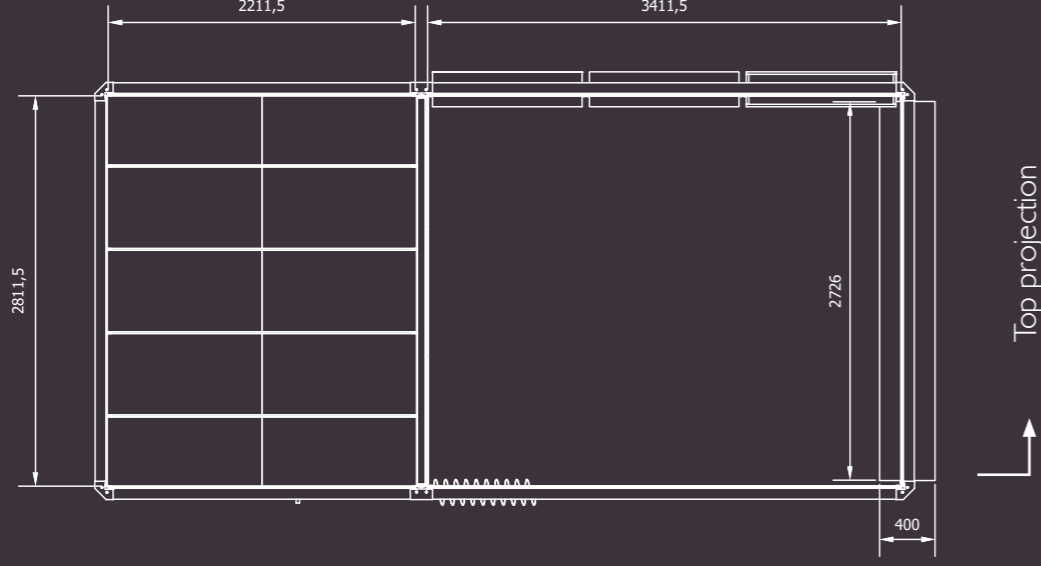
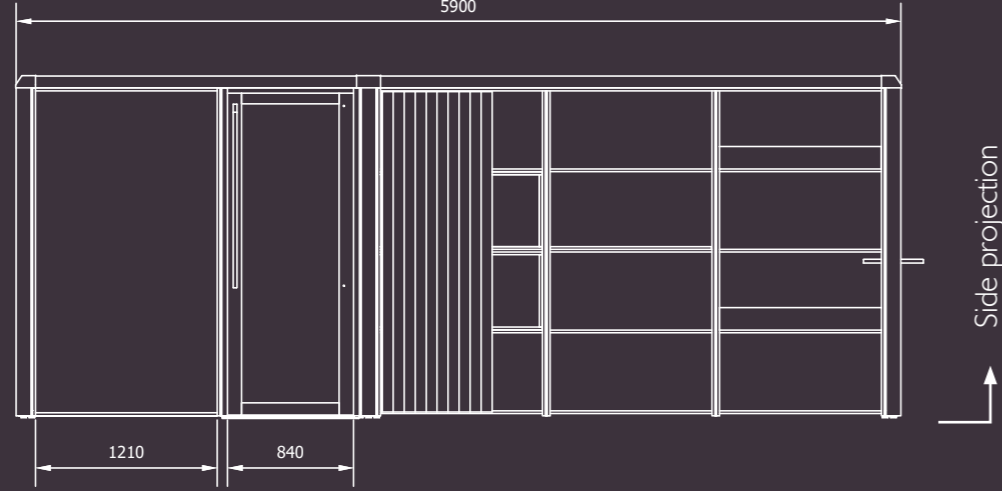
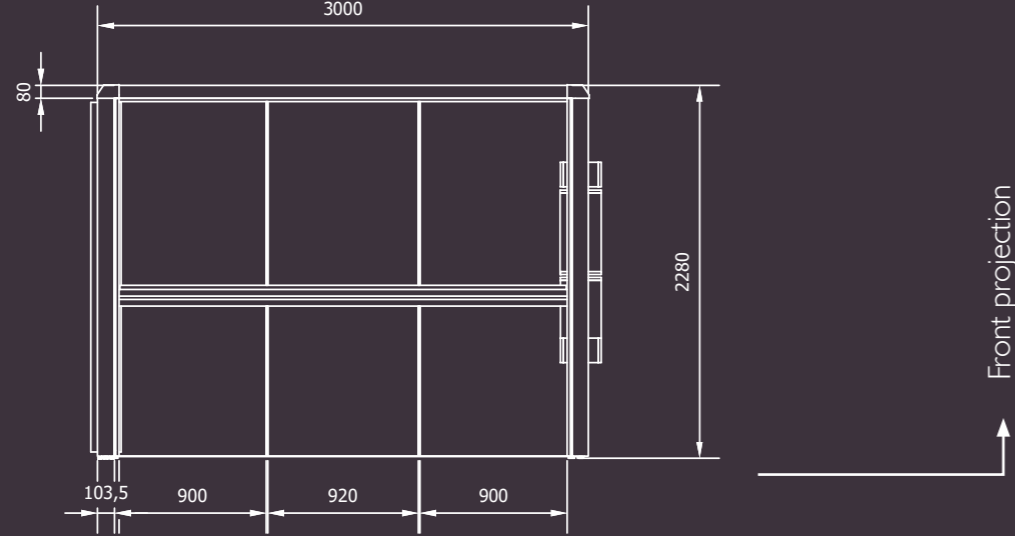

All measurements  
are in millimetres



# Quad Quarters

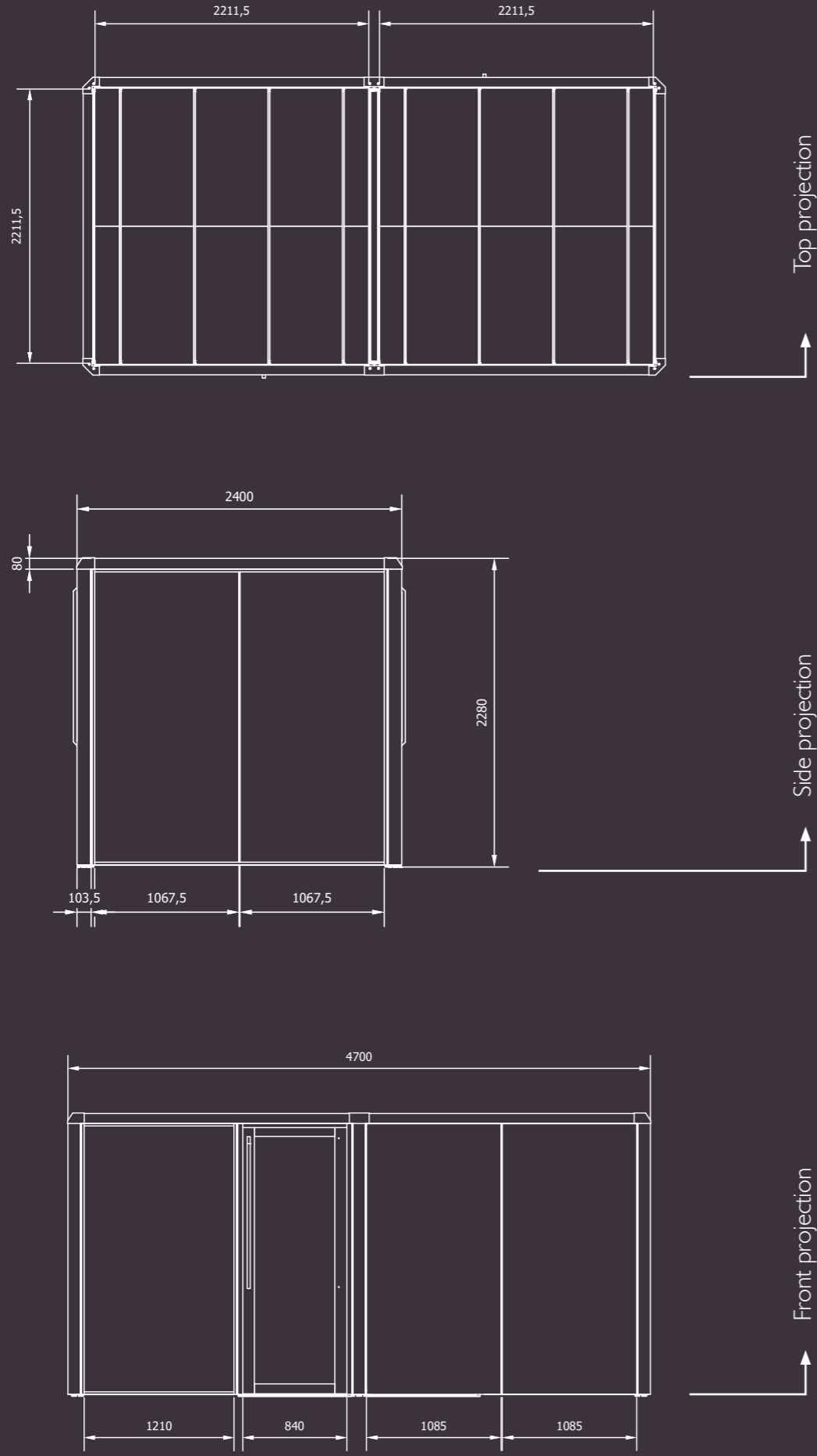

All measurements  
are in millimetres



# Collaborative Coves

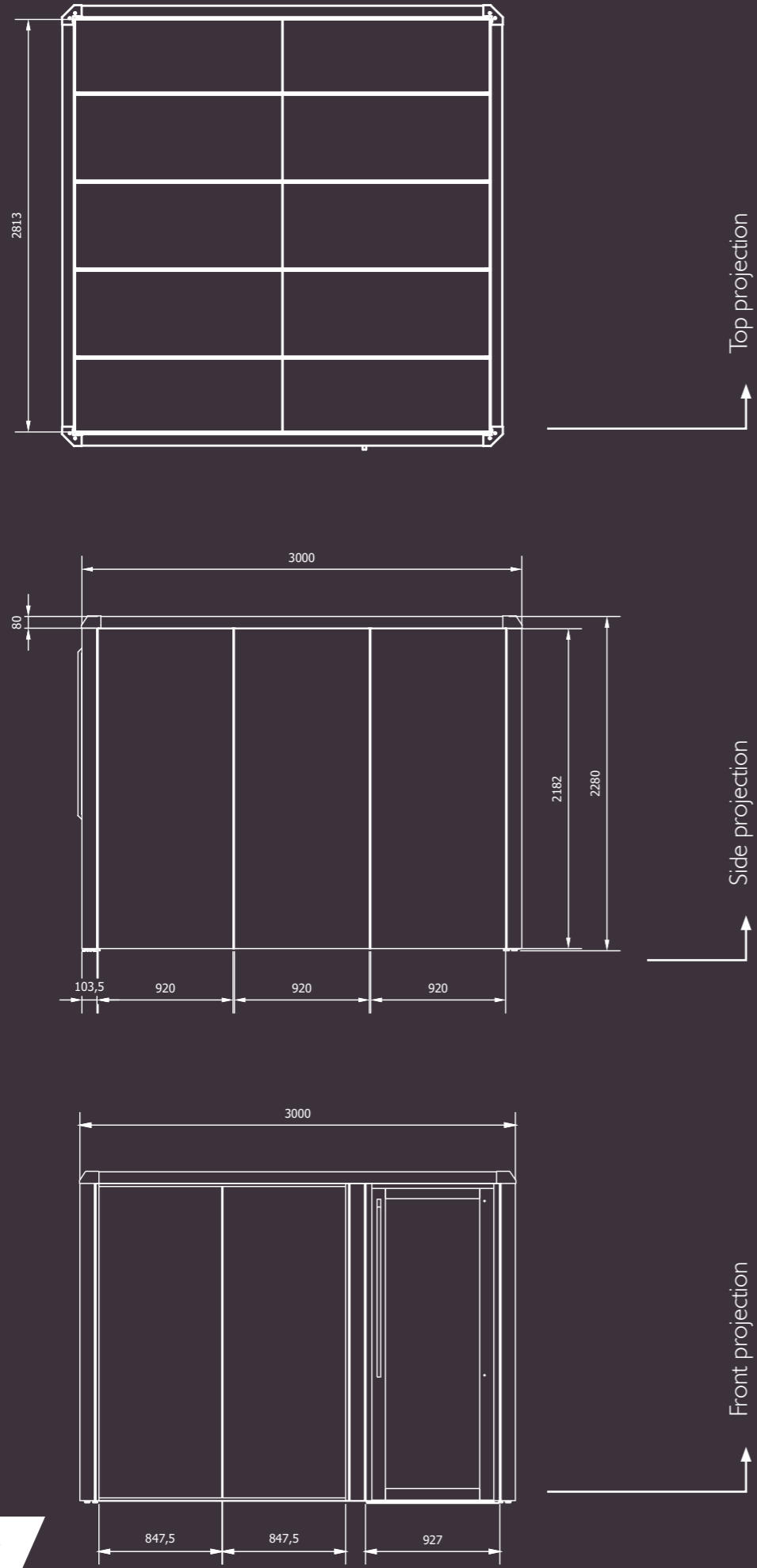

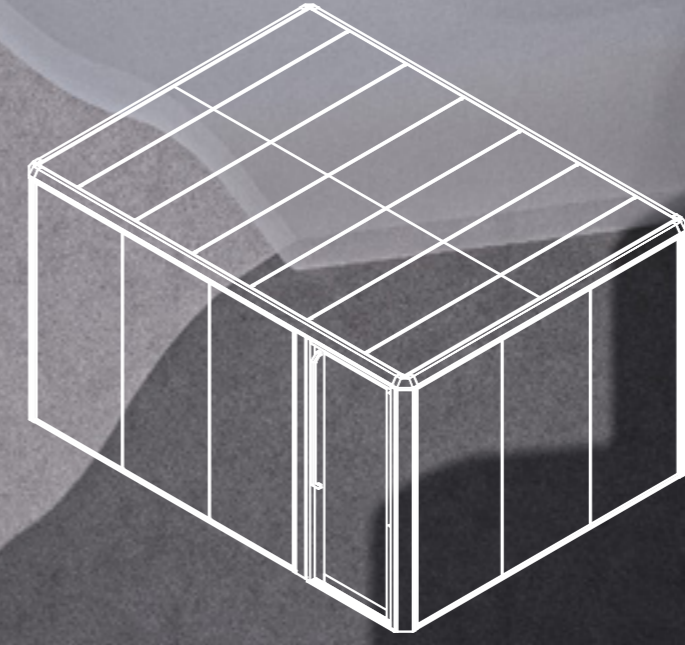
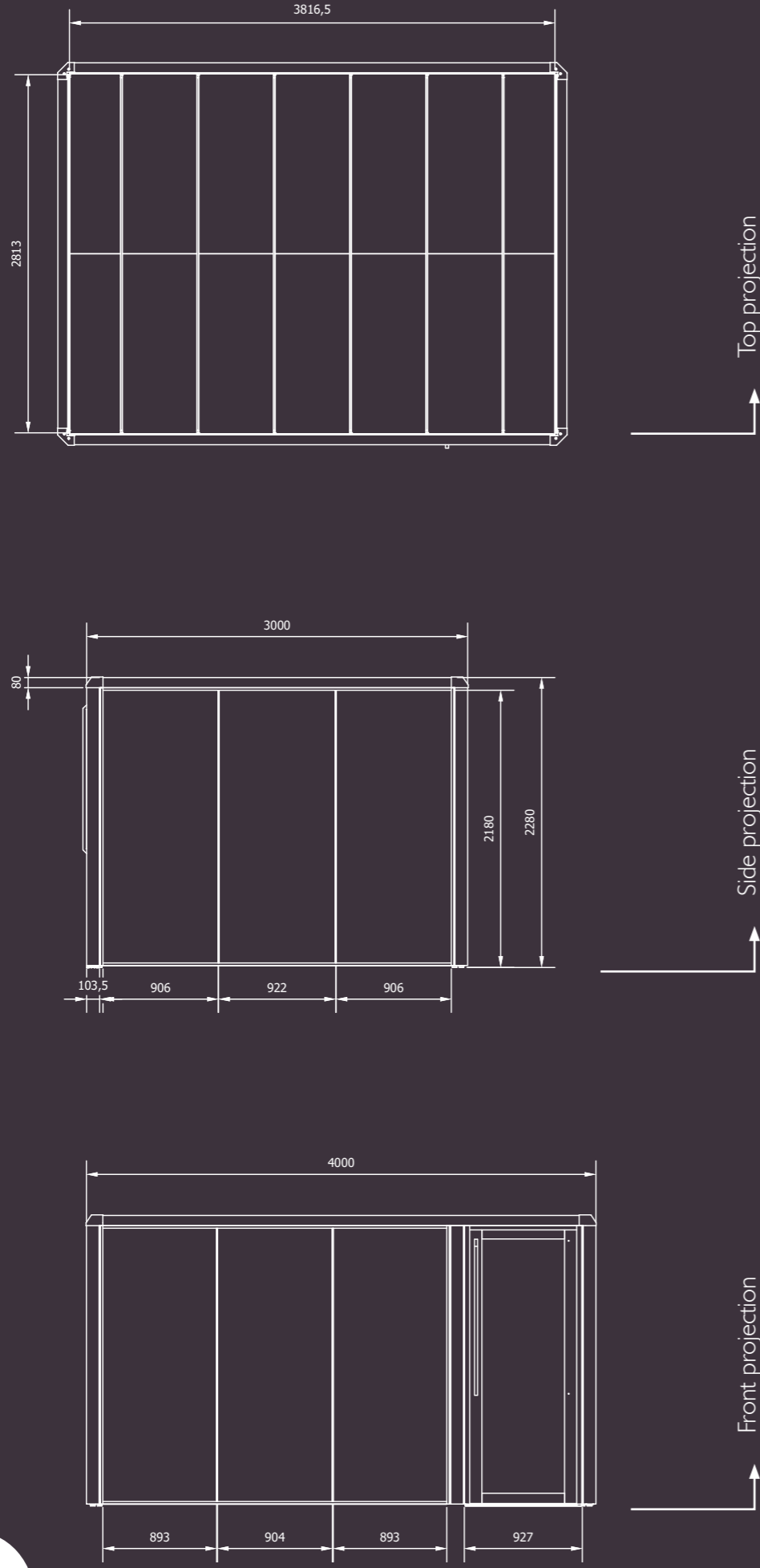

All measurements  
are in millimetres



# Hive Hub

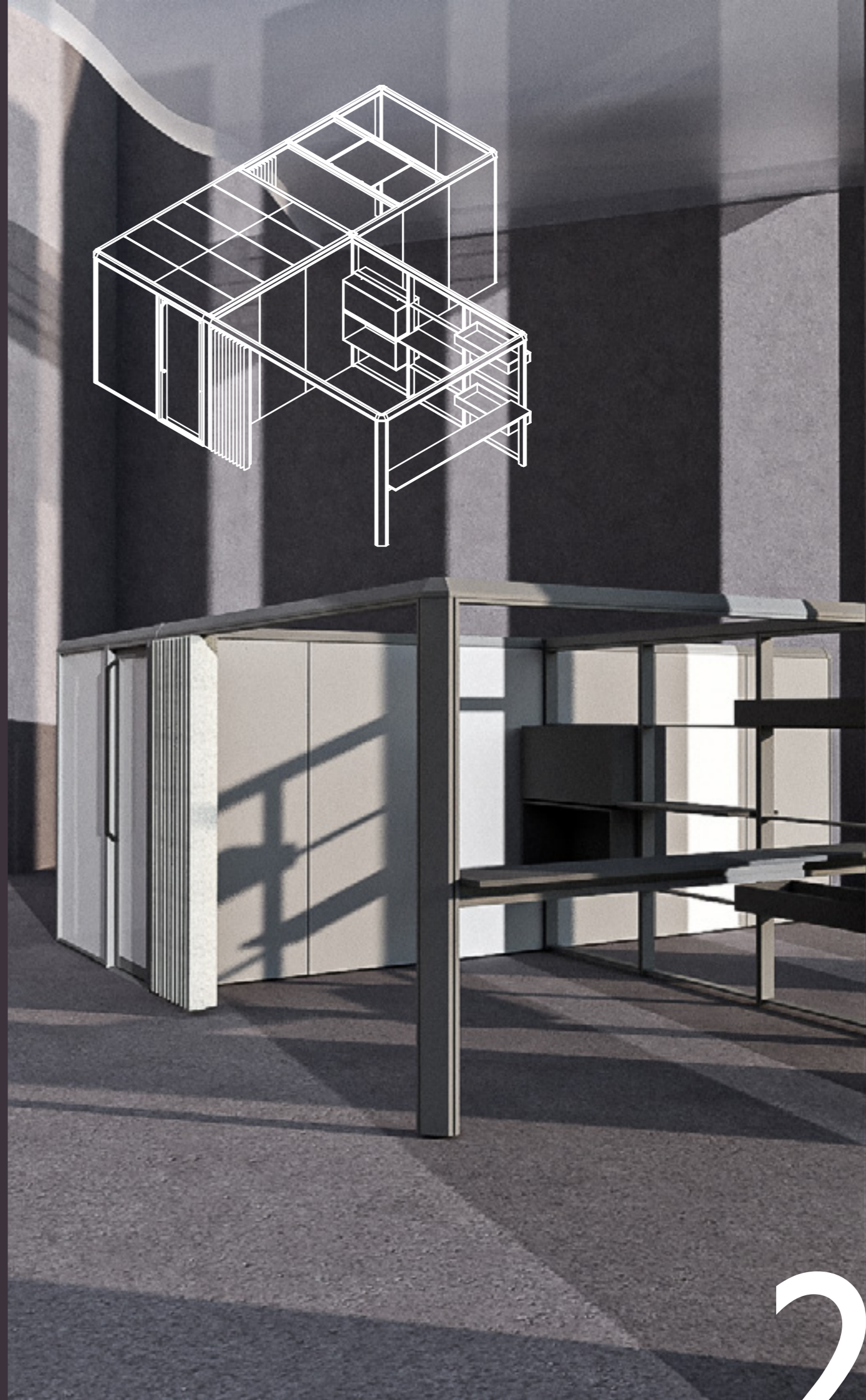
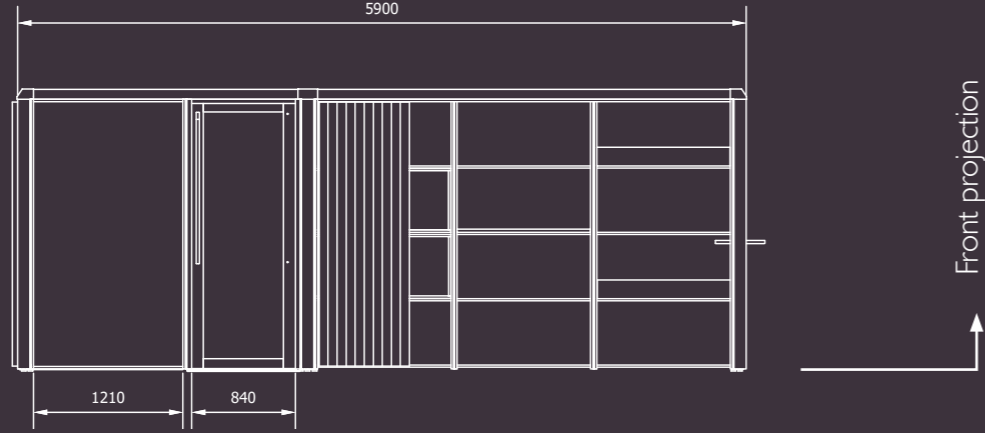
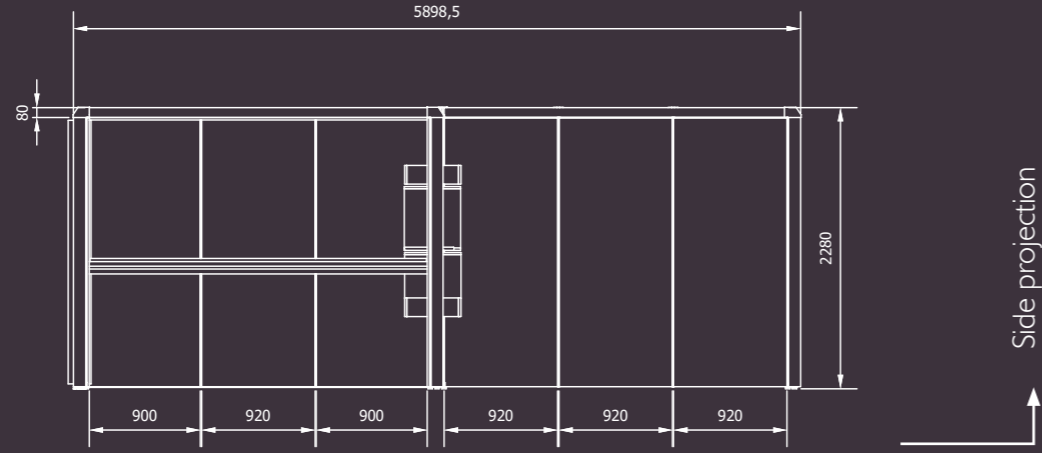
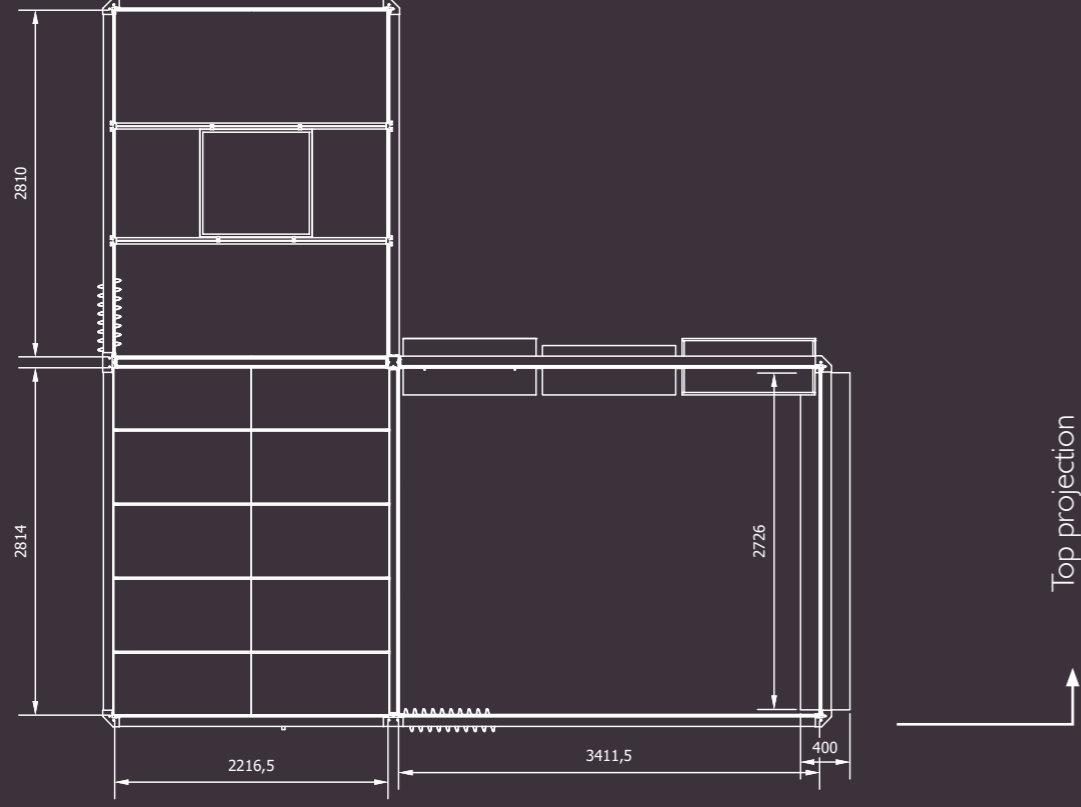

# Finishes

Clubhouse revolutionises office design, inspired by Francis Duffy’s visionary concepts in ‘The New Office’. KI shares Duffy’s belief in creating collaborative and community-oriented workspaces. With Clubhouse, we reimagine the traditional office offering flexible solutions that adapt to modern business demands.

Incorporating Duffy’s ‘new kinds of office – the club’ concept our ground up system can be configured into phone booths or larger structures. Clubhouse fosters interaction, privacy, and seamless technology integration. Embracing Duffy’s forward-thinking, KI provides endless customisation options for frame structures, walls, shelving, and more. Empower your business with dynamic, inspiring environments that enhance productivity and employee satisfaction. Experience the future of the workplace with Clubhouse!

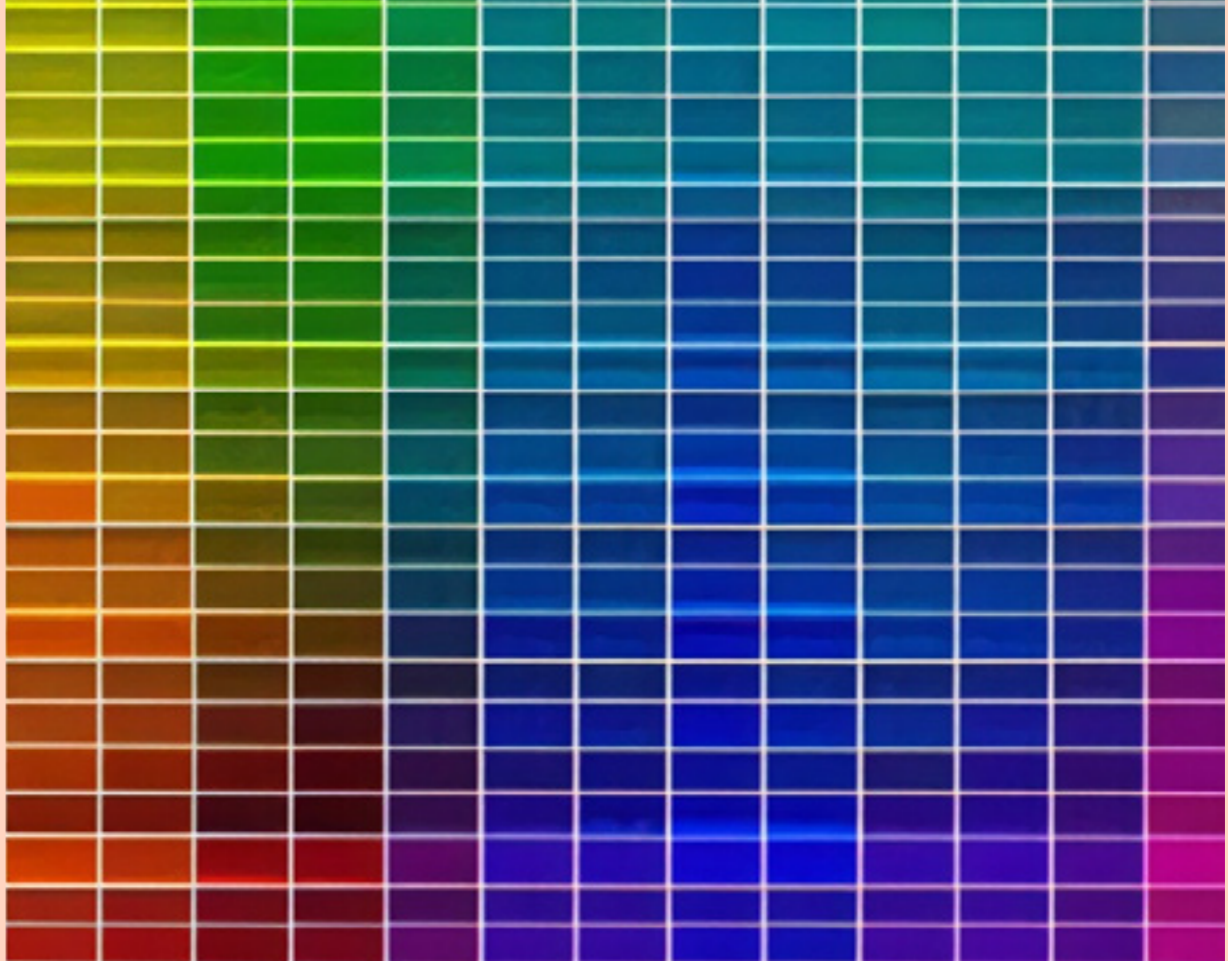

Customise Clubhouse to reflect your unique style. With a wide range of customisation options, you can personalise every aspect; from the frame colour to the walls, shelving accessories and curtains, the choices are vast. With Clubhouse, the possibilities for creating your perfect workspace are limitless.

To ensure accurate colour matching, we kindly request Pantone or RAL references. Please note that additional surcharges may apply.

Contact your Sales representative for more details.



